

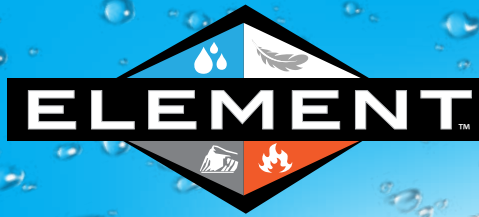

**COMPOSITE SHUTTLE BUSES
BUILT FOR THE FUTURE TODAY**





COMPOSITE TECHNOLOGY



■ Ducted System with evenly placed HVAC is the Lightest AC on the market today

■ Tinted Bonded Passenger Windows and Ceiling-Mount LED Interior Main Lighting

■ Smooth White Fiberglass Interior Walls and Seamless Composite Floor

■ FeatherRock Composite Wall Construction and One-Piece Seamless Composite Roof

■ Driver / Passenger Matching Recovers and No lower condenser behind driver.

■ Full Seamless Fiberglass Exterior

■ Driver and Passenger Running Boards along with Full Composite Exterior Skirting



FIRE

With our composite and insulation technology, we are the most thermally protected shuttle bus in the industry today.



AIR/FEATHER

We will be 500-850 pounds lighter on a 24' bus. Weight savings drives better fuel mileage and provides added passenger capacity.



WATER

Composites are impervious to moisture- our construction eliminate the damage from rain, sleet, humidity and snow. Rusting issues are no longer a concern



ROCK

Exterior fiberglass on all sides protects against road debris, dents, scratches, and daily exterior abuse/damage that happens with buses.

HOW IT'S MADE

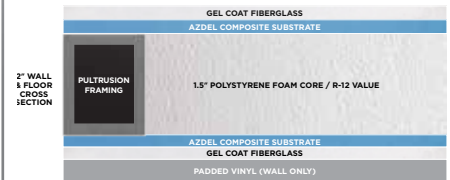

We are a one-piece, composite barrier providing an exterior barrier (less dust, debris inside) and a stronger surface that won't dent/separate.

TOP FEATURES go to website for all features & options

- Ducted System- Evenly HVAC Displacement
- Lightest AC on the market
- Tinted Bonded Passenger Windows
- Ceiling Mount LED Interior Main Lighting
- FeatherRock Composite Wall Construction
- FeatherRock One Piece Seamless Composite Roof
- FeatherRock Seamless Composite Floor
- Driver and Passenger Running Boards
- Seamless Fiberglass Exterior
- Smooth White Fiberglass Interior Walls
- Element Entrance Handrails
- Element Modesty Panels/ Safety Stanchions
- Wall mount/ Single Leg Seating for more storage
- Adjustable Q-Strait Seat tracking
- Easy Removable B-Pillar Interior Panels
- Easy Removable Overhead transition covers
- No lower condenser behind driver
- Dual USB ports
- LED Exterior Lights
- Dual USB Ports
- CHMSL- Center Brake Light
- Aisle-Side Arm rests
- Entry Door Exterior LED Light
- CHMSL- Center Brake Light

FLOOR PLANS

See our website for all of the floor plans available right now. The first units will be Embassy Element Bus models at limited sizes.

SCAN OR VISIT SITE TO SEE ALL 5 LAYOUTS

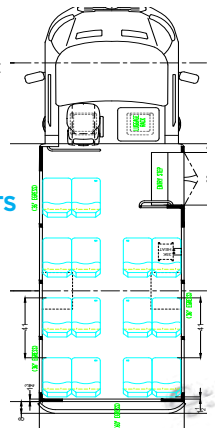

elementbus.com



2104 Aeroplex Drive N / Suite 101 / Elkhart, IN 46514 / 574-333-3733